

Panther™

panthercarts.com

LARGE WHEEL NURSERY PUSH CART MODEL H3034 INSTRUCTION SHEET



COPYRIGHT © JUNE, 2004 BY GRIZZLY INDUSTRIAL, INC.
**WARNING: NO PORTION OF THIS MANUAL MAY BE REPRODUCED IN ANY SHAPE
OR FORM WITHOUT THE WRITTEN APPROVAL OF GRIZZLY INDUSTRIAL, INC.**
#CA6393 PRINTED IN CHINA

PARTS INVENTORY

The Model H3034 was carefully packed when it left our warehouse. If you discover this cart is damaged after you have signed for delivery, *please immediately call Customer Service at (570) 546-9663 for advice.*

Save the containers and all packing materials for possible inspection by the carrier or its agent. *Otherwise, filing a freight claim can be difficult.*

When you are completely satisfied with the condition of your shipment, you should inventory the contents.

Figure 1 - Frame Components.

A.	Base	1
B.	Right Fence	1
C.	Left Fence	1
D.	Tailgate.....	1

Figure 2 - More Components

A.	Wheels	2
B.	Legs.....	2
C.	Support Bar	1
D.	Handle	1
E.	Axle	1
F.	Bolt Bag.....	1
	—Flat Washers 20mm	2
	—Cotter Pins 4mm x 42mm	2
	—Hex Bolts M8-1.25 x 15	2
	—Hex Bolts M8-1.25 x 40	9
	—Hex Bolts M8-1.25 x 30	4
	—Hex Bolts M8-1.25 x 45	2
	—Lock Nuts M8-1.25	17
	—Flat Washers 8mm	17
	—Slotted Screws M6-1 x 70	2
	—Lock Nuts M6.....	2

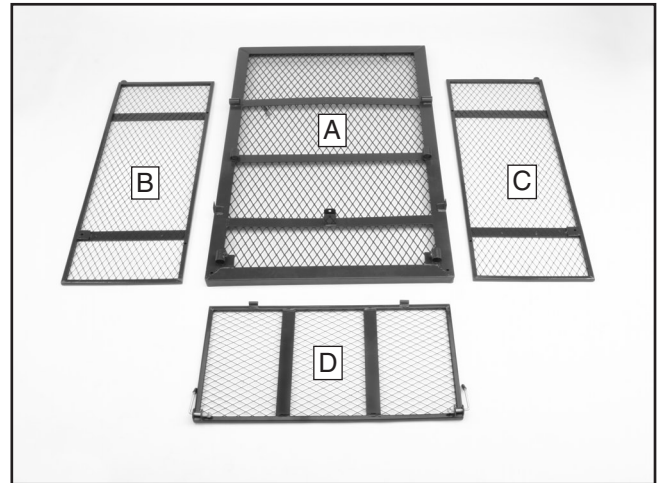

Figure 1. Frame components.

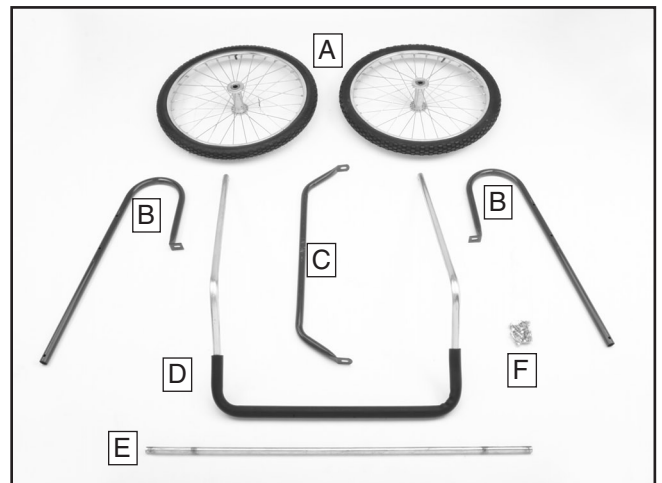

Figure 2. More components.

⚠️ WARNING

Children may climb into plastic bags and suffocate. Keep all plastic bags included in packaging out of the reach of children.

⚠️ CAUTION

Adult supervision is always required while this wagon is being used by children.

ASSEMBLY INSTRUCTIONS

When assembling the Model H3034, tighten all nuts and bolts finger tight, then, when the cart is assembled, tighten all nuts and bolts firmly.

FENCES, HANDLES, AND LEGS

1. Bolt the fence sides to the inside of the base using the M8-1.25 x 30 hex bolts, flat washers, lock washers, and hex nuts.
2. Install the tailgate with the hinges facing out, using the M6-1 x 70 slotted screws and lock nuts as shown in **Figure 3**.

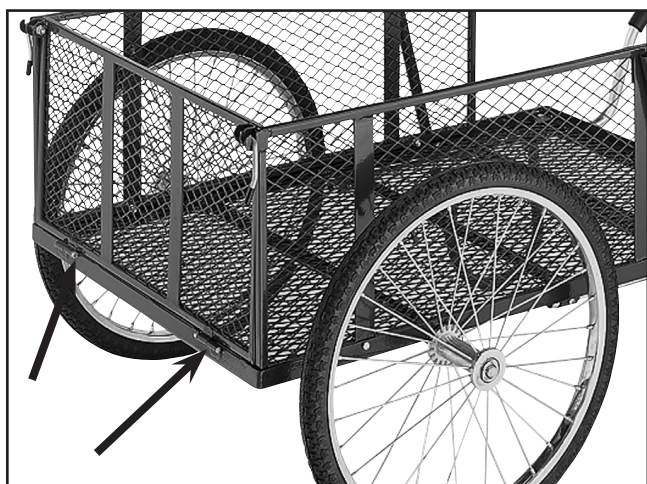

Figure 3. Tailgate hinges.

3. Bolt the legs to the base (**Figure 4**) using M8-1.25 x 40 hex bolts, flat washers, and lock nuts. Bolt them to the sides using M8-1.25 x 45 hex bolts, flat washers and lock nuts.



Figure 4. Leg and handle installation.

4. Slide the handle through the handle housing rings and fasten with M8-1.25 x 40 hex bolts, and lock nuts for the ends, and M8-1.25 x 16 hex bolts for the threaded housing rings (**Figure 4**).
5. Place the support bar in the bracket on the base and bolt the ends to the legs with M8-1.25 x 40 hex bolts, flat washers and lock nuts (**Figure 4**).
6. Secure the support bar in the bracket with a M8-1.25 x 40 hex bolt, flat washer and lock nut (**Figure 4**).

AXLE AND WHEELS

1. With the cart upside down, place the axle through the axle housing on the bottom of the base.
2. Place a wheel and a 20mm flat washer on each axle end.
3. Insert and spread a cotter pin through each axle.

If you need additional help with this procedure, call our service department at: (570) 546-9663.

H3034 Parts Breakdown and List

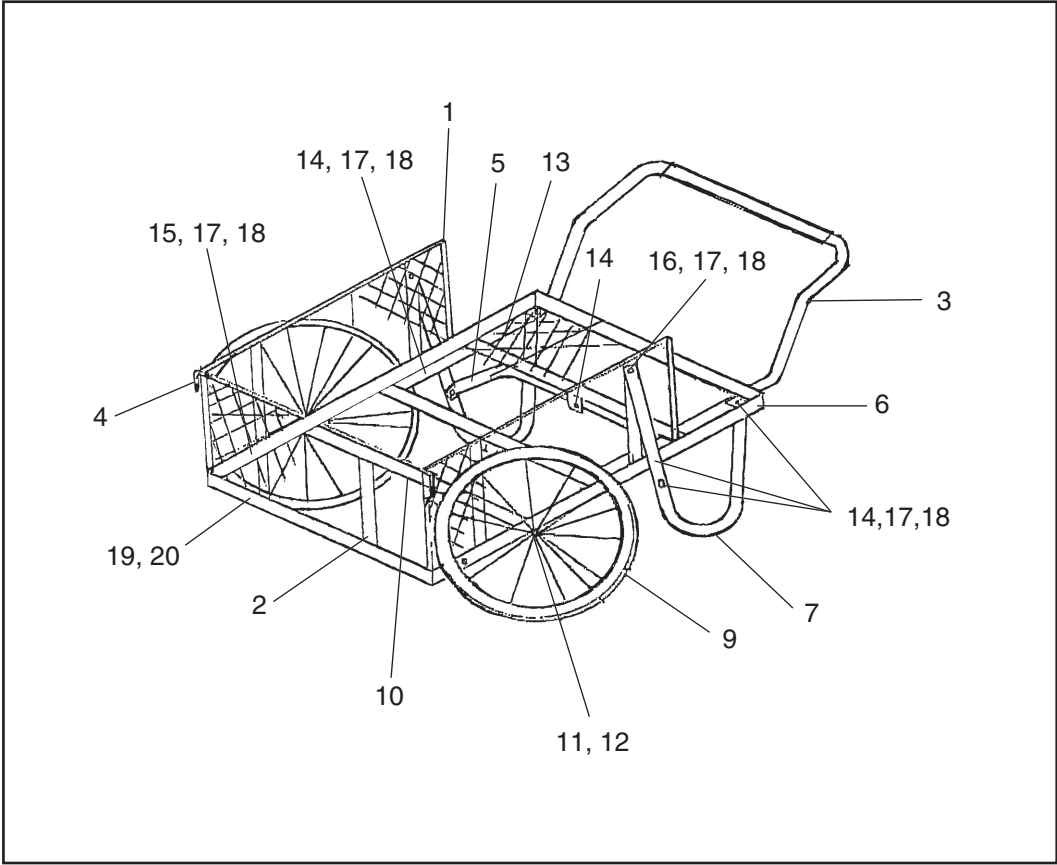

REF	PART#	DESCRIPTION
1	PH3034001	FENCE
2	PH3034002	TAILGATE
3	PH3034003	HANDLE
4	PH3034004	TAILGATE LATCH
5	PH3034005	SUPPORT BAR
6	PH3034006	BASE
7	PH3034007	LEG
9	PH3034009	WHEEL 26 X 2.125
10	PH3034010	AXLE
11	PW13M	FLAT WASHER 20MM

REF	PART#	DESCRIPTION
12	PH3034012	COTTER PIN 4MM X 42MM
13	PB03M	HEX BOLT M8-1.25 X 16
14	PB15M	HEX BOLT M8-1.25 X 40
15	PB26M	HEX BOLT M8-1.25 X 30
16	PB118M	HEX BOLT M8-1.25 X 45
17	PLN04M	LOCK NUT M8-1.25
18	PW01M	FLAT WASHER 8MM
19	PS90M	PHLP HD SCR M6-1 X 70
20	PLN03M	LOCK NUT M6-1